

PARTS LIST for the *Parker*

# *Springfield*

**LAWN  
SWEEPER**

Model SP-49



**PARKER PATTERN & FOUNDRY CO.**

Springfield, Ohio

*Parker* "THE ORIGINAL NAME IN LAWN SWEEPING"

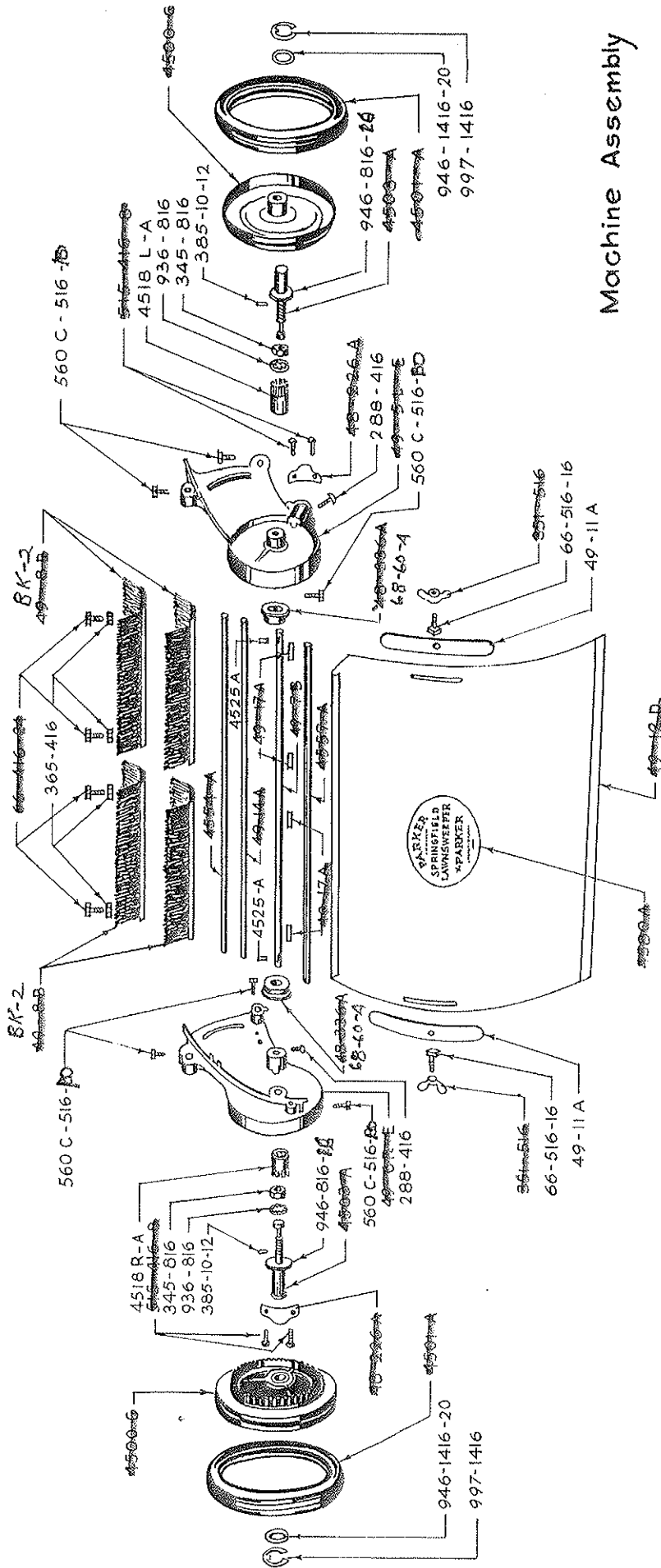

Machine Assembly

# Basket Assembly

(49-192 HANDLE ASS'Y)

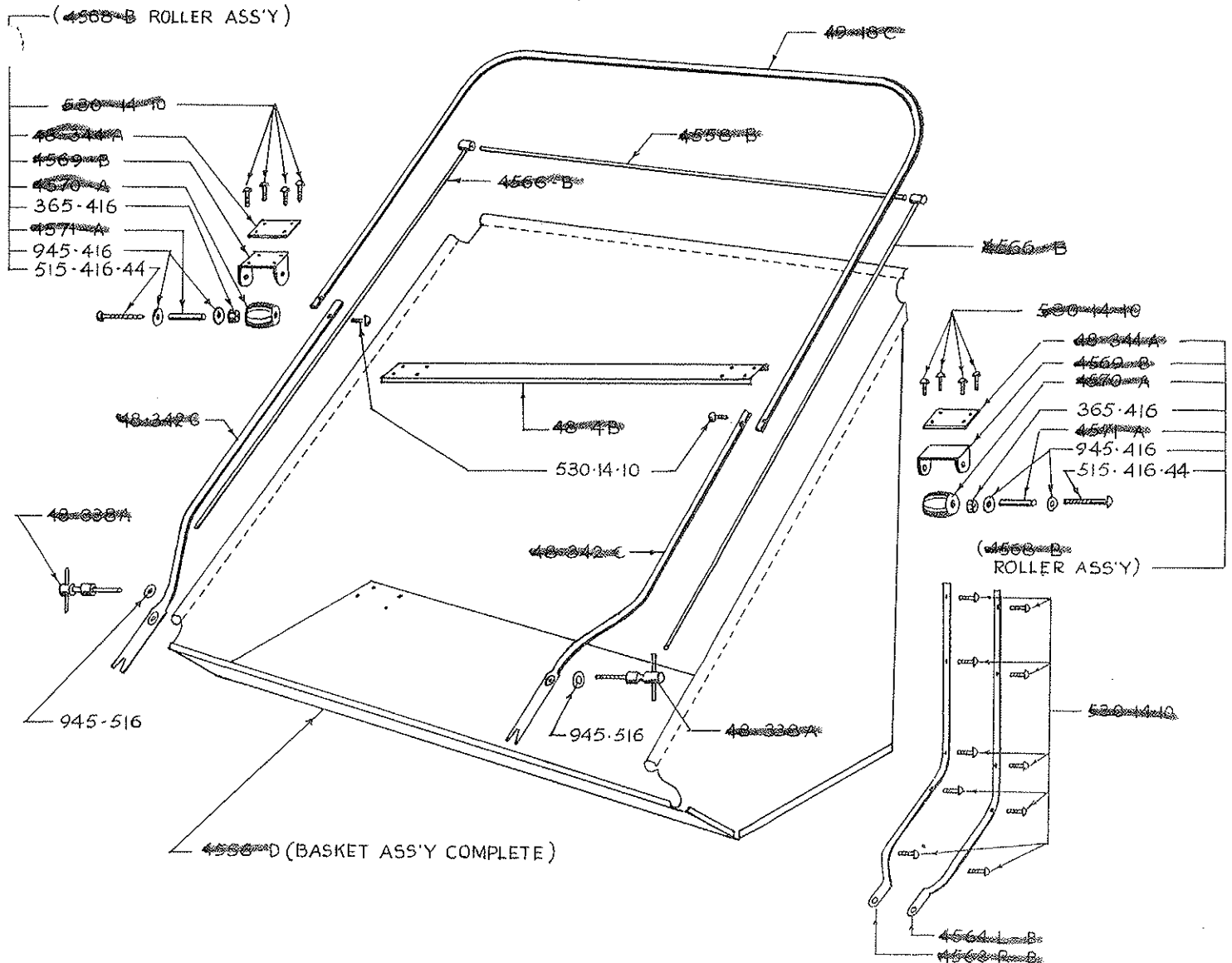

## PARTS LIST FOR 28" MODEL SP-49 "PARKER" SPRINGFIELD LAWN SWEEPER

PART No.	NAME	PART No.	NAME	PART No.	NAME
4568-C	10.25 x 1.50 Inverted Rim Wheel.	4568-F	Ball Bearing. 68-60-A	945-416	1/4" Wrought Washer.
4568-B	10.25 x 1.50 Semi-pneumatic Tire.	4568-G	Adjustment Screw (Ass'y.)	945-516	5/16" Wrought Washer.
4568-A	Axle Stud.	4568-H	Lower Handle Section.	997-1416	3/8" Retaining Ring.
4518R-A	Right Hand Pinion Gear.	4568-I	Caster Reinforcement Plate.		
4519L-A	Left Hand Pinion Gear.				
4525-A	Pawl.	4568-J	Left Hand Side Plate.	66-516-16	1/4" - 20 x 1 1/2" Lg. Sq. Head Bolt.
4564-L	Rear Tie Rod.	4568-K	Right Hand Side Plate.	385-10-12	5/16" - 18 x 1" Lg. Sq. Head Bolt.
4568-D	Basket Assembly (complete).	4568-L	Reel Shaft.		No. 0 Taper Pin.
4567-A	Front Tie Rod.	4568-M	Brush Assembly. BK-2	515-416-44	1/4" - 20 x 1/2" Lg. Rd. Hd. Screw.
4568-E	Basket Cross Rod.	49-11A	Hood Reinforcement.	650C-516-40	1/4" - 20 x 2 3/4" Lg. Rd. Hd. Screw.
4568-F	Right Hand Basket Support.	4568-N	Hood Assembly.		No. 14 x 3/8" Lg. Sheet Metal Screw.
4568-G	Left Hand Basket Support.	4568-O	Top Tie Rod.		5/16" - 18 x 1/2" Long Cup-point
4568-H	Basket Spring.	4568-P	Brush Bracket.	946-816-16	Square Head Set Screw.
4568-I	Roller Assembly.	4568-Q	Upper Handle Section.	946-1416-20	Fiber Washer.
4568-J	Roller Fork.	4568-R	Handle Assembly (complete).		Fiber Washer.
4570-A	Rubber Roller				
4571-A	Roller Axle.	288-416	1/4" Flush Type Oiler.		
4568-A	Decalcomania.	345-816	1/2" - 20 Hex Jam Nut.		
		66-516	5/16" - 18 Wing Nut.		
		365-416	1/4" - 20 Lock Nut.		
		936-816	1/2" Shakeproof Lock Washer.		
4568-L	Reinforcement Channel.			4568-S	EXTRA EQUIPMENT
4568-M	Pinion Cover.			4568-T	Wire Brushes.
				4568-U	Bailing Canvas.
				4568-V	Wind Apron.
				4568-W	Disposal Canvas.

## ASSEMBLY AND OPERATING INSTRUCTIONS FOR YOUR SPRINGFIELD LAWN SWEEPER

This sweeper is packed in two cartons.

One Carton contains:

Quantity	NAME	Part No.
1	Sweeping Unit Assembly	49-225A

One Carton contains:

Quantity	NAME	Part No.
1	Basket Assembly Complete:	49-226A
1	Basket Cross Rod (attached)	4558-B
2	Basket Springs	4566-B
1	Upper Handle Section	49-18C
2	Lower Handle Sections	48-342C

This sweeper is very easily set up if the following instructions are adhered to:

1. Remove adjustment screws (48-338A), washers and sheet metal screws from lower handle section. (48-342C).
2. Telescope lower handle sections with curve to inside (48-342C) into upper handle section (49-17C). Line up holes and insert bolt (515-10-16) and tighten down securely.
3. Start in the back of Basket Canvas and slip handle through the seams provided, down the sides of the basket.
4. Place basket springs (4566-B) over ends of basket cross rod (4588-B), (found in top of basket) and lay on top side of basket, insert end of cross rod into holes in upper handle section (49-18C). Handle can be sprung open enough for this operation.
5. Slip lower ends of handle between side plates and pivot ends on axle studs. Keep basket supports (4563-RB and 4564-LB) on the outside of the side plates.
6. Line the hole in the basket support up with the slot in the side plate and place one washer (945-516) between the basket support and side plate.
7. Slip the adjustment screw (48-338A) through the hole in basket support, washer, washer and side plate and screw into handle.
8. Repeat operations No. 6 and No. 7 on other side of machine. The shoulder on the adjustment screw should fit in the hole in the basket support. Tighten adjustment screws.
9. Raise handle up and the basket will take shape. Bend basket springs and place ends in the holes provided in basket bottom.
10. The sweeper is now ready for use after adjusting the brush for the desired pressure on the surface.

### TO ADJUST BRUSHES:

Adjust the brushes to contact the grass just as lightly as possible as this will make the brushes last much longer and the machine run more easily. To adjust brushes, loosen the adjustment screw (48-338A) found on both right and left sides of the sweeper. Raise or lower the brush to the desired pressure on the ground and retighten adjustment screws.

The purpose of the basket springs is to support the handle when the machine is non-operative, and to permit the quick lowering of the handle when in use, thus reaching sudden depressions in the ground or barren places on the lawn. The lowering of the handle automatically lowers the brush.

The brushes will last for years under proper care. However, they may become bent under constant use, in which case they should be dampened and then corubed out with your fingers, or in severe cases removed from the reel and reversed in position. Brushes may easily be replaced when worn out.

### TO REPLACE BRUSHES:

Release the tension on the basket springs by taking them from their hole sockets in the basket bottom and then lay the machine on the floor, bottom side up.

Remove the four self-locking nuts and bolts and the brushes will be free. Replace with new ones and secure with nut and bolt.

### 11. TO ADJUST HOOD:

The hood is very easily adjusted for any desired height by loosening the two wing nuts on the front of the hood and raising or lowering the hood to suit. The hood should be lowered practically to the ground for short grass, barren ground or when sweeping driveways or sidewalks. It can be raised all the way up for sticks, stones, bones and other objects.

### 12. LUBRICATION:

The machine comes to you lubricated, ready for use. The brush reel is mounted on ball bearings and is factory packed with grease. There are conveniently located flush type oilers in the side plates for occasional oiling. Wheel bearings should be occasionally lubricated with medium grade oil.

### 13. STORAGE:

For convenience in storing remove basket springs from holes in metal bottom which will permit the basket and handle to collapse. Hang sweeper on hooks off the floor against wall.

14. For convenience, sweepings may be dumped into a large 7' x 7' canvas and carried to the point of disposal. You can have this canvas made or we can supply on demand. (4588-C.)

15. For parts or service, see your nearest Parker dealer, or write factory direct. Order all parts by part number and model of sweeper (found on side plate), and refer to serial number (found on guarantee card).

16. To make valid your guarantee make certain you have returned your serial identification card. If any cause for complaint or service should arise, refer to your serial number on guarantee, and return inspection slip. Parts prices are available upon application.