

ASSEMBLY INSTRUCTIONS  
OPERATING INSTRUCTIONS  
AND PARTS LIST  
FOR

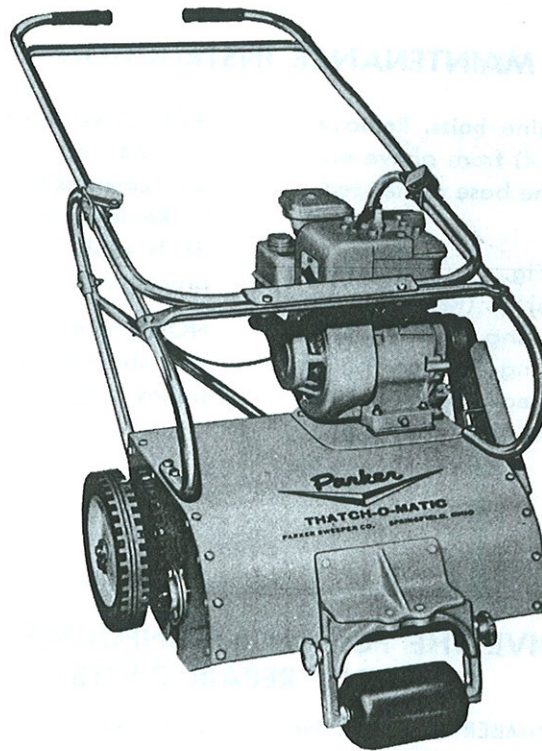

**THATCH-O-MATIC**  
**MODEL PR-6616**

POWER RAKE



NOTICE: These instructions were written to assist you in assembling your Power Rake quickly and correctly. Read instructions thoroughly before attempting assembly so that you are familiar with the complete procedure.

**PARKER SWEEPER COMPANY**

BOX 720

SPRINGFIELD, OHIO

## ASSEMBLY INSTRUCTIONS

1. Remove Power Rake from carton and place on ground or floor in upright position.
2. Remove upper part of handle from individual carton. Insert lower end under anchor plate, Item 18, Figure 1. Place handle in channel by turning locks, Items 9 and 11, Figure 1, and secure into place by turning locking cams into position.

## OPERATING INSTRUCTIONS

1. **IMPORTANT:** Before starting engine, read engine manual and add oil and gasoline as instructed.
2. Reset front roller to middle position. This is correct position for normal use.
3. When starting engine, throttle handle must be in idle position because at higher RPM's the centrifugal clutch releases power to belt. Note: If engine fails to start, slightly increase throttle.
4. Operate engine at full throttle and work machine slowly across lawn for proper results.
5. If lawn is exceptionally tall, occasionally lift up on handle to permit thatch concentrations to escape.
6. Avoid stops on lawn for even a few seconds unless engine is idling or tines are raised above ground.

## MAINTENANCE INSTRUCTIONS

1. To tighten belt, loosen four engine bolts. Remove shims (Ref. Nos. 69 and 70, Fig. 4) from above engine base and insert under engine base as needed. Retighten engine bolts.
  2. To replace tines (Ref. No. 47, Fig. 3) (A) remove two hex hd. bolts and lock washers (Ref. Nos. 30 and 41, Fig. 3) which hold bearing (Ref. No. 40) and lower half of aluminum casting (Ref. No. 39) to side plate at side opposite the sheave (Ref. No. 51, Fig. 3). Remove lower half casting at this point.  
(B) Remove three hex hd. bolts and lock nuts (Ref. Nos. 64 and 65, Fig. 3) which hold smaller aluminum castings (Ref. Nos. 43, 45 and 49) to reel shaft.  
(C) Remove two halves of tine assembly (Ref. No. 38).  
(D) To replace new tine assembly reverse the above procedure.
- NOTE: When reassembling pulley, grease end of reel shaft to prevent parts from rusting together; pulley should be flush with end of reel shaft.

### ALWAYS GIVE THE FOLLOWING INFORMATION WHEN ORDERING REPAIR PARTS:

**IMPORTANT**

1. PART NUMBER (Not Ref. No.)
2. QUANTITY NEEDED
3. DESCRIPTION OF PART
4. SERIAL No. (Found on Guarantee Card)
5. MODEL No. PR-6616

If unable to obtain parts locally, write down above information and send to:  
PARKER SWEEPER CO., BOX 720, SPRINGFIELD, OHIO 45501

Your unit is right hand (R.H.) or left hand (L.H.) as you stand behind it.

<b>THATCH-O-MATIC POWER RAKE</b>	<b>SIZE 16"</b>	<b>PRODUCTION YEAR 1966</b>	<b>MODEL No. PR-6616</b>
--------------------------------------	---------------------	---------------------------------	------------------------------

**PARTS LIST**

Ref. No.	Part No.	Qty. Per. Unit	Description of Part	Ref. No.	Part No.	Qty. Per. Unit	Description of Part
1	<del>65-416-C</del>	1	Handle — Upper	41	936-516	6	Washer — Lock Int. Tooth $\frac{3}{16}$
2	<del>65-275-B</del>	1	Brace — Cross-Upper	42	60-62-A	16	Pin — Roll $\frac{1}{8}$ Dia. x $\frac{3}{4}$
3	365-416	22	Nut — Hex Lock Elastic $\frac{1}{4}$ -20	43	<del>64-100-RR</del>	2	Bracket — Segment R.H.
4	65-416-20	9	Bolt — Hex Head $\frac{1}{4}$ -20 x $1\frac{1}{2}$	44	<del>63-124-A</del>	4	Rod — Spring
5	<del>64-150-A</del>	2	Grip — Hand	45	<del>64-102-B</del>	2	Bracket — Segment-Center
6	364-216	13	Nut — Hex Lock Elastic Thin $\frac{1}{4}$ -20	46	946-916-1216	96	Washer — Fiber
7	59-77-A	5	Clamp	47	60-92-B	104	Tine — Spring
8	<del>65-591-F</del>	2	Handle — Lower	48	<del>64-94-A</del>	4	Rod — Spring Retainer
9	65-420-LA	1	Bracket — Cam Lock L.H.	49	<del>64-101-LB</del>	2	Bracket — Segment L.H.
10	<del>65-552-C</del>	1	Brace — Cross	50	<del>564-C-546-4</del>	1	Screw — Allen Hd. Set $\frac{3}{16}$ -18 x $1\frac{1}{4}$
11	<del>65-419-RA</del>	1	Bracket — Cam Lock R.H.	51	<del>64-98-A</del>	1	Sheave
12	65-516-24	2	Bolt — Hex Head $\frac{3}{16}$ -18 x $1\frac{1}{2}$	52	<del>65-203-C</del>	1	Support — Roller
13	<del>61-13-A</del>	2	Insert <b>75-30-A</b>	53	<del>61-97-C</del>	1	Bracket — Roller
14	65-516-16	2	Bolt — Hex Head $\frac{3}{16}$ -18 x 1	54	<del>61-96-B</del>	2	Pin
15	365-516	12	Nut — Hex Lock Elastic $\frac{3}{16}$ -18	55	<del>59-47-B</del>	2	Knob — Adjusting
16	<del>65-415-B</del>	1	Brace — Cross-Lower	56	945-516	2	Washer — Flat S.A.E. $\frac{3}{16}$
17	65-416-12	10	Bolt — Hex Head $\frac{1}{4}$ -20 x $\frac{3}{4}$	57	935-516	2	Washer — Spring Lock $\frac{3}{16}$
18	<del>65-416-A</del>	1	Bracket — Handle	58	70-516-32	2	Bolt — Carriage $\frac{3}{16}$ -18 x 2
19	65-416-16	4	Bolt — Hex Head $\frac{1}{4}$ -20 x 1	59	946-1016-16	2	Washer — Fiber
20	65-416-8	8	Bolt — Hex Head $\frac{1}{4}$ -20 x $\frac{1}{2}$	60	<del>62-92-B</del>	1	Roller
21	<del>63-126-0C</del>	1	Side-Plate Assembly R.H.	61	<del>61-100-A</del>	2	Bearing — Nylon
22	<del>63-97-B</del>	2	Plate — Reinforcing	62	<del>63-132-A</del>	1	Key — Special Hi-Pro $280-9$
23	<del>63-232-CB</del>	1	Deflector	63	<del>64-99-B</del>	1	Shaft — Reel
24	<del>66-361-A</del>	2	Wheel	64	363-516	3	Nut — Hex Lock Elastic $\frac{3}{16}$ -24 N.F.
25	<del>63-41-F</del>	1	Plate — Back	65	<del>64-97-A</del>	3	Bolt — Special $\frac{3}{16}$ -24 N.F. x $1\frac{1}{4}$
26	<del>63-295-B</del>	1	Axle	66	<del>65-535-A</del>	1	Engine — 4-H.P. B. & S.
27	380-432-20	2	Pin — Cotter $\frac{1}{8}$ Dia. x $1\frac{1}{4}$	67	<del>64-67-A</del>	1	Clutch — Centrifugal
28	945-1216	3	Washer — Flat S.A.E. $\frac{3}{4}$	68	61-65-A	1	Key — Engine $\frac{3}{16}$ sq. x $1\frac{1}{4}$
29	<del>63-253-A</del>	3	Washer — Special	69	<del>63-186-A</del>	2	Shim — Engine $\frac{3}{16}$
30	65-516-12	10	Bolt — Hex Head $\frac{3}{16}$ -18 x $\frac{3}{4}$	70	<del>63-255-A</del>	4	Shim — Engine $\frac{1}{4}$
31	<del>65-532-C</del>	1	Drag-Strip-Assembly	71	65-516-28	2	Bolt — Hex Head $\frac{3}{16}$ -18 x $1\frac{3}{4}$
32	<del>57-170-A</del>	2	Pin — Roll $\frac{1}{2}$ Dia. x $1\frac{1}{2}$	72	<del>63-44-A</del>	1	Belt
33	<del>63-127-LG</del>	1	Plate — Side-Assembly L.H.	73	<del>63-33-C</del>	1	Plate — Engine Outer
34	<del>63-129-A</del>	1	Bracket — Mounting-Assy. — Guard	74	<del>63-39-B</del>	1	Plate — Engine Inner Assy.
35	<del>63-32-C</del>	1	Guard — Belt	75	563-C-416-4	1	Screw — Set Allen — $\frac{1}{4}$ -28 N.F. x $\frac{1}{4}$
36	<del>63-90-B</del>	1	Support Angle	76			
37	<del>63-40-F</del>	1	Hood	77			
38	<del>64-95-B</del>	Set of 2	Tine Assembly	78			
39	<del>63-30-C</del>	4	Bracket — Segment	79			
40	<del>64-96-A</del>	2	Bearing — $\frac{1}{4}$ Bore	80			

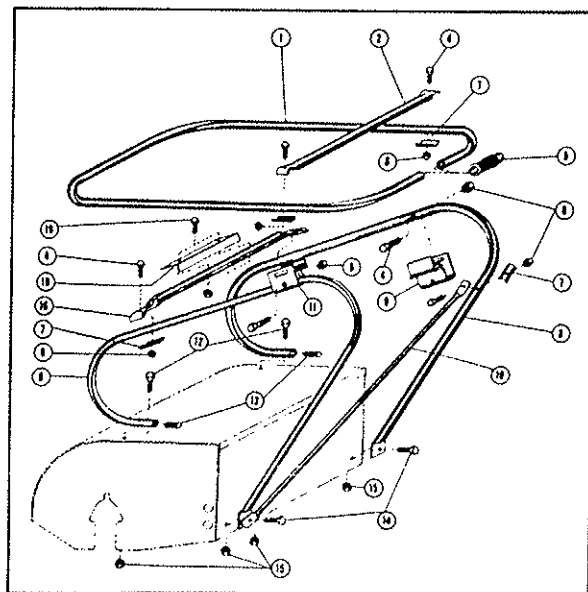

FIGURE 1

